

The Manchester Land Conservation Trust, owner of the 62-acre farm on Bush Hill Road, asks...

What if the proposed subdivision had been built?

The very character of the Town would change if this were a housing development. With your help, we are preserving this open space, and improving air and water quality. Help us pay off the \$210,000 mortgage that the Manchester Land Trust needed to take out in order to complete the purchase. Info: www.manchesterlandtrust.org

**62 house lots
proposed for
this property**

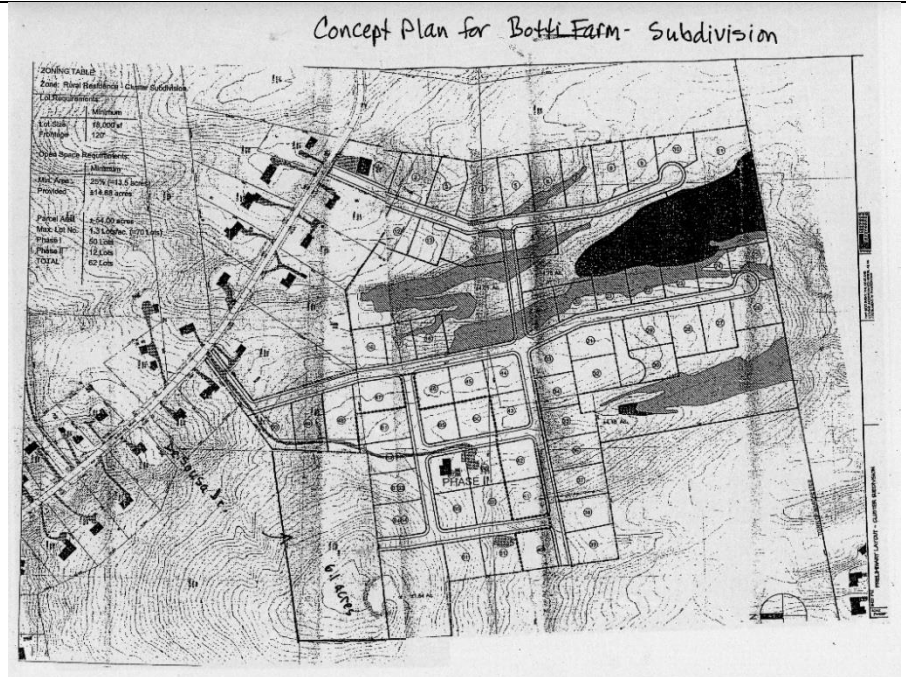

**Botti Farm
Estates
“Active Adult”
community
proposed
2007**

